

# SX115 User Guide



Copyright © 2025 Martin Audio Limited  
Publication date 2025-05-14



## Table of Contents

Introduction .....	3
Optional accessories .....	4
Set of four castors WHEELKIT .....	4
Weatherised connector cover WRKIT .....	4
Transit cover SX115TC .....	4
M10 eye bolt HTKCT06 .....	4
Wind-up telescopic pole ASF20071 .....	4
Flying grid SXGRIDI15 .....	5
Set of four flying strips FKIT450 .....	5
Connecting the SX115 .....	6
Link cable .....	6
Weatherising the SX115 .....	7
To fit the weatherised connector cover .....	7
Fitting castors .....	8
To fit castors .....	8
Flying a single SX115 .....	9
To fly a single SX115 .....	9
Flying an array of SX115 .....	10
To fly an array of SX115 .....	11
To add subs to the array .....	12
Flying SX115 above WPM .....	13
To fly SX115 above WPM .....	13
Flying SX115 above Torus T8 .....	14
To fly SX115 above Torus T8 .....	14
Installing a pole .....	15
To install a pole .....	15
SX115 amplifier compatibility .....	16
System controllers .....	17
Using other controllers .....	17
System design .....	18
To download Display 3 .....	18
EASE Focus data .....	18
3D SketchUp file .....	18
Revit family .....	18
DWG file .....	18
Other SX subwoofers .....	19
SX115 specification .....	20
SX115 technical drawing .....	21
Troubleshooting .....	22
Technical support .....	22
Service .....	22
Warranty .....	22
Unpacking .....	22
Recycling .....	22

## Introduction



the iKON amplifiers (iK41, iK42 and iK81). If you use a DX series controller, you also need an amplifier, such as the VIA5002.

The SX115 is available exclusively in black. With the addition of an optional connector cover, the SX115 is weather resistant and suitable for outdoor use. Castors and transit cover are available as optional accessories.

The SX115 is a versatile, passive subwoofer featuring a powerful long-excursion 15" (380 mm) driver with 4" (100 mm) voice coil driver, water-resistant cone and triple roll surround. It delivers dynamic low-frequency performance from a very compact enclosure. Four reflex ports increase LF output efficiency and have a large frontal area to reduce turbulent air noise at high sound levels.

The durable plywood enclosure is finished in hardwearing textured paint and incorporates threaded inserts for eye bolt suspension of a single enclosure, as well as safety points. Inserts allow attachment of side rigging strips for flying installed arrays of up to four enclosures.

Ergonomic pocket handles assist handling and installation. The driver is protected by a coated steel grille with an acoustically transparent fabric backing. An M20 threaded plate on the top surface allows pole-mounting of Martin Audio full-range enclosures.

The SX115 can be used as a stand-alone subwoofer or stacked using locating skids and mating channels at the base and top of each enclosure. Cardioid operation can be achieved by arranging the SX115 in forward and rear-facing pairs, with each enclosure powered individually in conjunction with dedicated DSP presets.

With a response of 45 Hz – 100 Hz  $\pm$  3 dB, the SX115 is ideal for use with Martin Audio point source systems (up to 12"), constant curve systems (such as TORUS 8) and line array systems (such as WPM). For crossover and EQ functions, we recommend the DX series controllers (DX0.4, DX0.6 and DX4.0) or the on-board processing of

## Optional accessories

### Set of four castors WHEELKIT

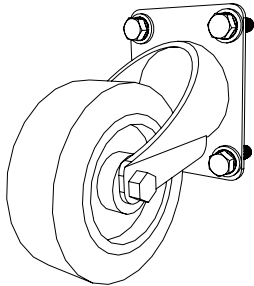

- Four heavy-duty 10 cm (4 in) swivel castors
- Fittings: 16 M8 hex head bolts, 16 flat washers and 16 spring washers
- Optional accessory for Martin Audio 15" and 18" subwoofers (SX115, SXC115, SXCF115, SX215, SX118, SXC118, SXCF118, SX218, SXP118, SXP218, Blackline X115, X118, X218, XP118)
- Supplied with SXH218 and SXHF218

### Weatherised connector cover WRKIT

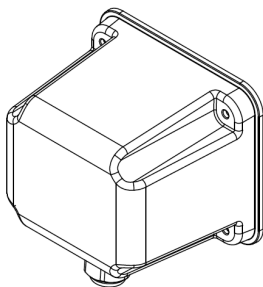

- Weatherised connector cover to protect the NL4 speaker connection and prevent water ingress
- Upgrades compatible subwoofers to IP24 rating
- Compatible with SX115, SX215, SX118, SXC118, SXCF118, SX218, SXH218 and SXHF218
- Two knockout holes, one on the side and one on the underside, allowing you to fit two cables or to choose where to fit one cable
- Contents of kit: connector cover, gasket, cable gland, lock nut, four cap head screws (M4 x 25 mm) and four fibre washers (M4)

### Transit cover SX115TC

- Tour grade transit cover
- Cut outs for easy access to handles
- Protects the SX115 in transit

### M10 eye bolt HTKCT06

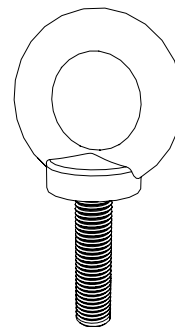

- M10 eye bolt for flying individual speakers
- Bolt size: 10 mm x 1.5 mm thread size
- Shank length: 35 mm (1 3/8 in)
- Working load limit: 740 kg (1,628 lbs)

### Wind-up telescopic pole ASF20071

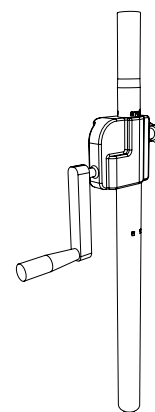

- Wind-up telescopic pole for mounting a portable speaker on a subwoofer
- Rugged steel pole with wind-up handle to allow you to raise and lower the speaker

- Locking screw and safety button
- Diameter: 35 mm (1 3/8 in) to fit standard top-hat fittings of portable speakers
- M20 threaded base fitting to attach to the subwoofer

## Flying grid SXGRIDI15

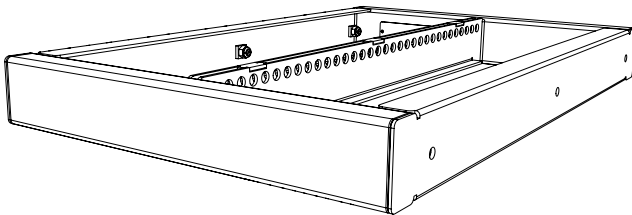

- Flying grid for arrays of SX115 or SXC115
- Fly arrays of SX115 or SXC115 above WPM or TORUS T8
- Installation not touring
- One or two-point pick-up
- Available in black (SXGRIDI15) and white (SXGRIDI15-W)
- Previous product code: SXC115GRIDI

## Set of four flying strips FKIT450

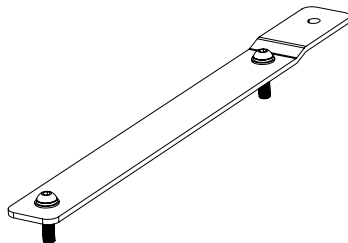

- Flying strips for SX115 only
- Each flown SX115 needs one set
- Installation not touring
- Contents: four bolt-on strips, eight hex button head bolts (M10 x 50 mm), eight spring washers (M10), eight plain washers (M10)

## Connecting the SX115

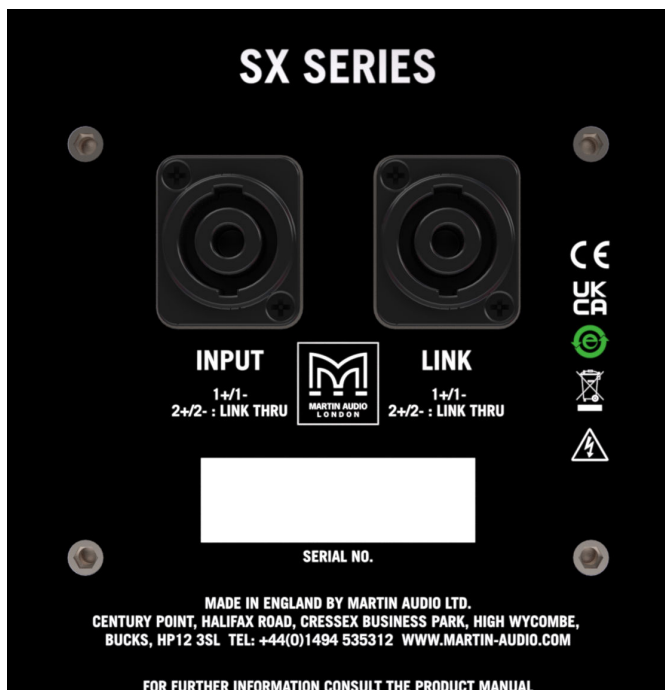

The SX115 has two NL4 sockets on the back panel, labelled INPUT and LINK. Despite the labels, the two sockets are the same, so you can use them either way round. For both sockets, the pins connect as follows:

- Pins 1+/1– connect to the driver.
- Pins 2+/2– connect to pins 2+/2– of the other socket for use as a link.

### Link cable

To link through to another speaker, use a cable where pins 2+/2– of the link connector connect to pins 1+/1– of the input connector for the other speaker.

# Weatherising the SX115

To weatherise the SX115 for outdoor use, you just need to fit an optional weatherised connector cover [WRKIT \(page 4\)](#). The rest of the subwoofer is already prepared.

The connector cover protects the NL4 connection and prevents water ingress. It upgrades the SX115 to an IP24 rating.

## To fit the weatherised connector cover

1. Remove one of the two knockouts from the connector cover. The knockout to use depends on your preferred cable angle. If you are using a link cable, remove both knockouts.
2. Fit the cable gland.
3. Feed the speaker cable through the gland and attach an NL4 connector. If the cable already has an NL4 connector, you will need to remove it first.
4. Remove the four screws from the connector panel on the back of the sub.
5. Plug in the NL4 connector.
6. Hold the cover and gasket in position and pull any excess cable through the cable gland.
7. Secure the cover using the fittings from the kit: these are four cap socket screws (M4 x 25 mm) and four M4 fibre washers.
8. Tighten the cable gland to ensure a waterproof seal.

# Fitting castors

To fit castors to the SX115 you need an optional [WHEELKIT \(page 4\)](#) accessory. This is a set of four swivel castors along with all required bolts and washers.

## To fit castors

1. Remove the M8 counter-sunk screws from the back of the SX115.

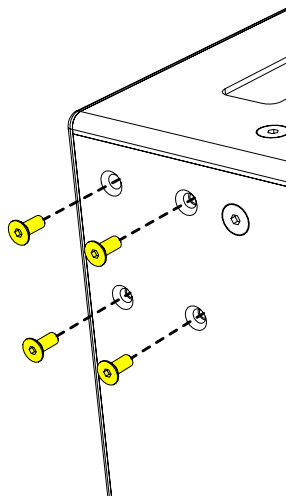

2. Bolt each castor in place using the fittings from the kit.

**Order of fittings:** cabinet, castor, flat washer, spring washer, bolt.

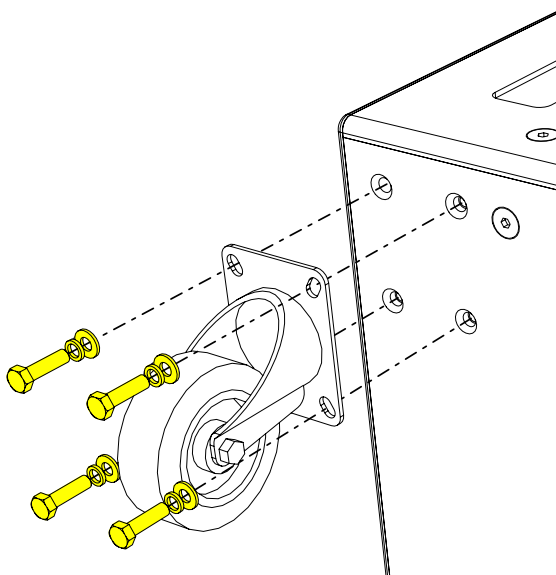

Make sure you use the bolts from the kit. The screws from the cabinet aren't suitable.



## Flying a single SX115

You can fly individual SX115 subwoofers from ceilings, trusses or poles by using Martin Audio M10 shouldered eye bolts (HTKCT06) and appropriately rated steel ropes or chains.



Eye bolts allow you to fly single subwoofers only.

Note that Martin Audio shouldered eye bolts are made of cast steel and are specifically engineered and rated for flown applications.



Don't use eye bolts from other manufacturers, as this could be dangerous.

Forged-steel eye bolts available from DIY suppliers are definitely not strong enough. Even cast or machined eye bolts rated for purpose can be unsuitable, as they can have wide shoulders that cause the bolt to tighten against the cabinet rather than the thread.

The SX115 has 24 M10 inserts: six on the top, six on the bottom, four on each side and four on the back.



Flying heavy equipment in public spaces is extremely dangerous. Make sure the installer uses appropriately rated equipment and has suitable qualifications and experience.

### To fly a single SX115

1. Remove some of the M10 counter-sunk screws from the SX115 (usually from the top) and screw in M10

eye bolts. We recommend five eye bolts: four to fly the subwoofer and one as a redundant safety bond.

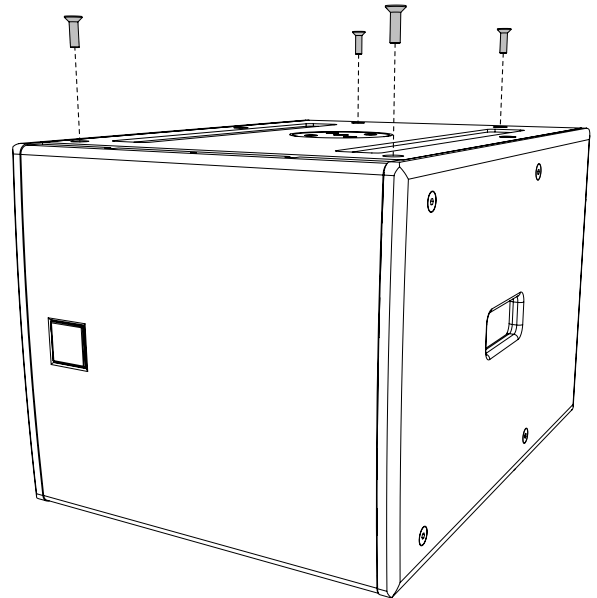

2. Install suitably rated fixings, such as sleeve anchors for ceilings, or girder clamps for trusses and scaffolding.

Install the safety bond fixing in a different place from the main fixings. This is so that it can support the cabinet if the main fixings fail.

3. Connect the eye bolts and fixings using suitably rated steel rope or shackles and chains.

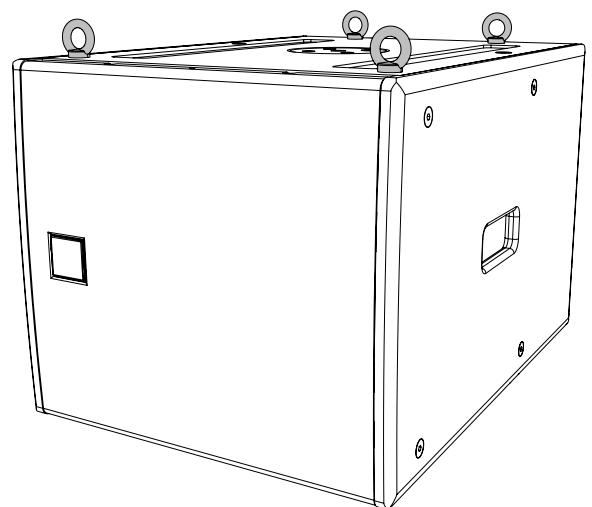

## Flying an array of SX115

To fly an array of SX115 subs, you need the following optional accessories:

- **SXGRIDI15 flying frame:** attach this to the top of the array.
- **FKIT450 flying kit:** you need one kit for each SX115.



These accessories allow you to fly a maximum of four SX115 subs.

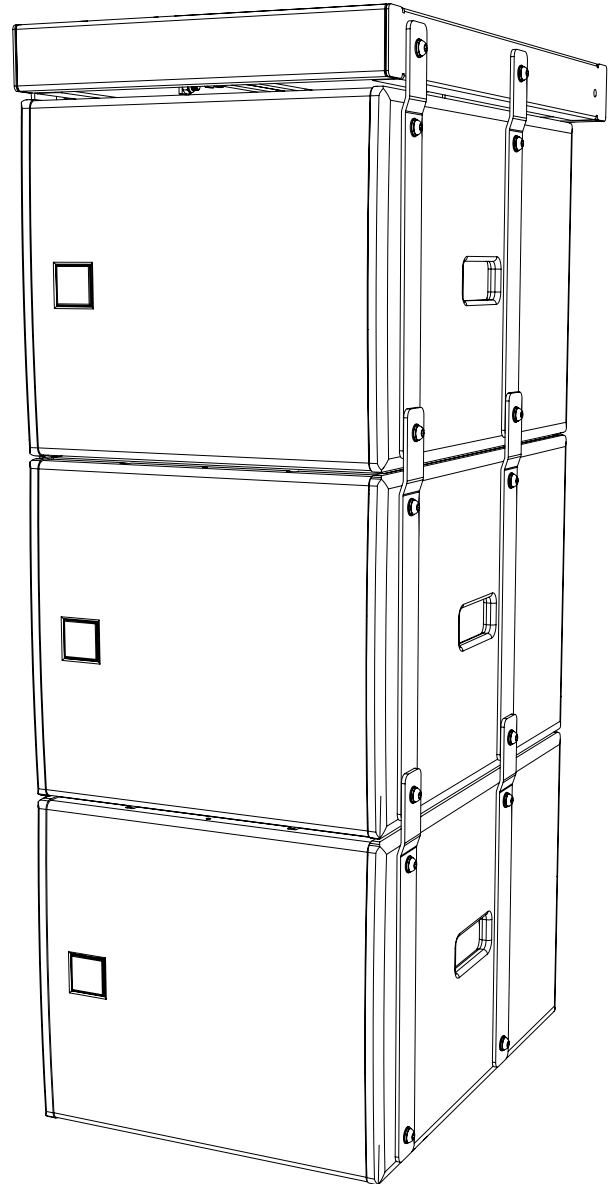

With a small array, it is easiest to stack the SX115 subs first and attach the fittings, as explained in the next section. If you don't want to stack the subs (for example, if you are on your own), you can attach the fittings to one sub, use a hoist to raise this sub in the air and then slide the next sub underneath. You can also use this method to create a large array by adding subs underneath a small array.



Flying heavy equipment in public spaces is extremely dangerous. Make sure the installer uses appropriately rated equipment and has suitable qualifications and experience.

## To fly an array of SX115

1. Remove the M10 bolts from the sides of the cabinets, four from each side.

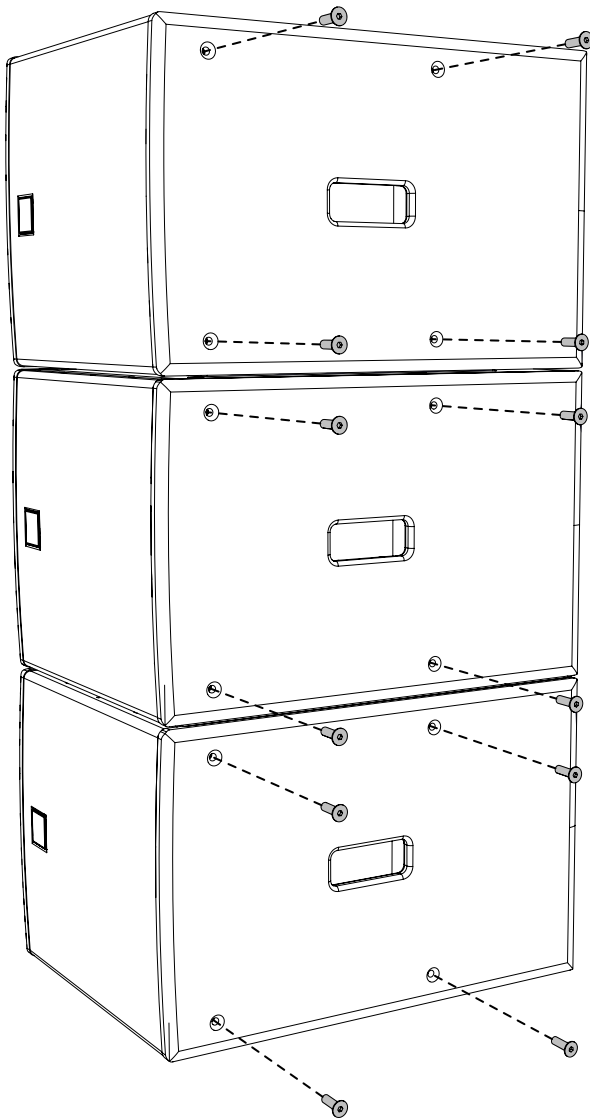

2. Secure four FKIT450 flying strips to each sub using the M10 screws and washers provided in the kit.

**Order of fittings:** flying strip, flat washer, spring washer, screw.



Make sure you use the screws from the flying kit, as the screws from the cabinet aren't suitable.

Each flying strip overlaps the flying strip on the cabinet above, so you may find it easiest to attach the strips from the bottom of the array.

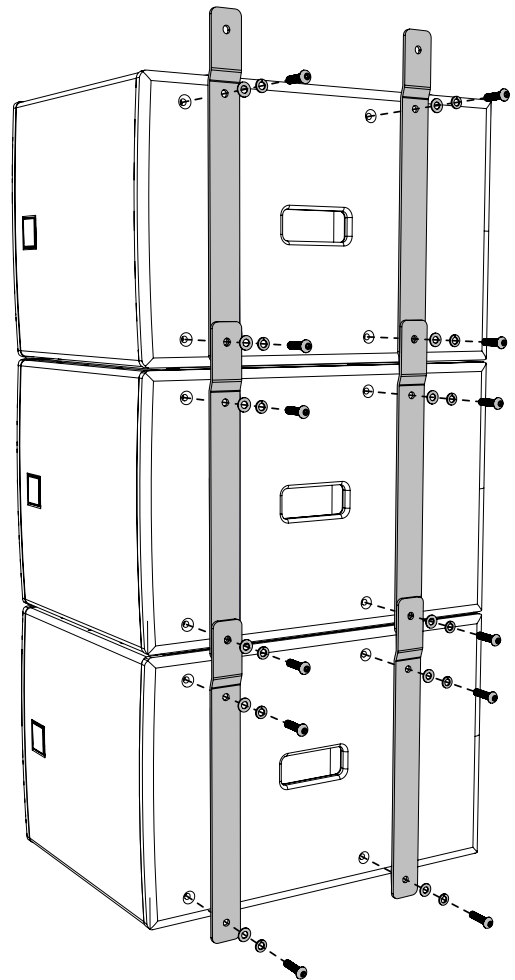

3. Place the SXGRID15 on top of the array.

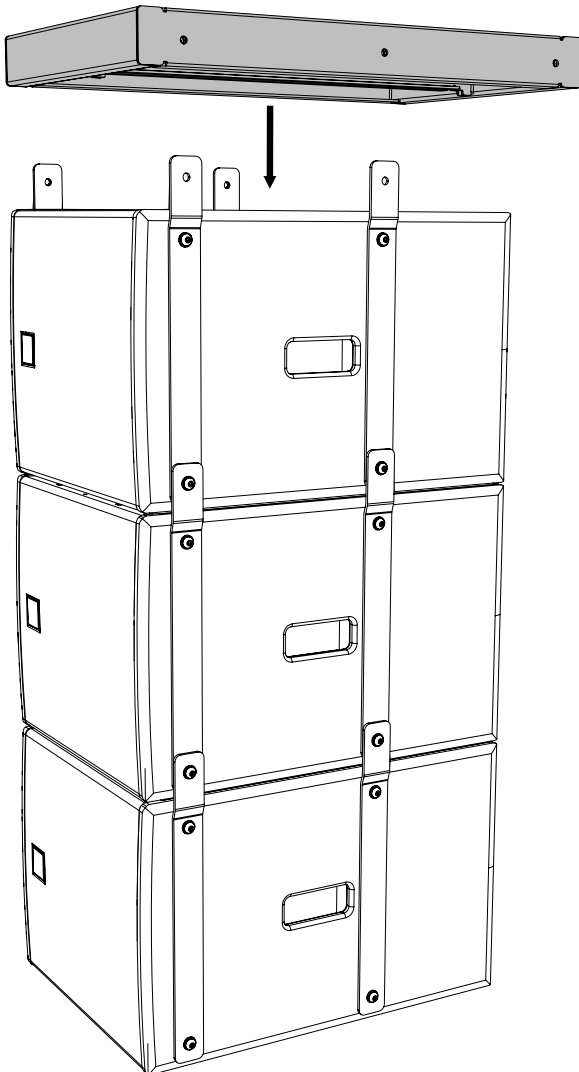

4. Align the holes in the flying strips and the grid, and secure on both sides using the screws and washers provided in the kit.

**Order of fittings:** flying strip, flat washer, spring washer, screw.

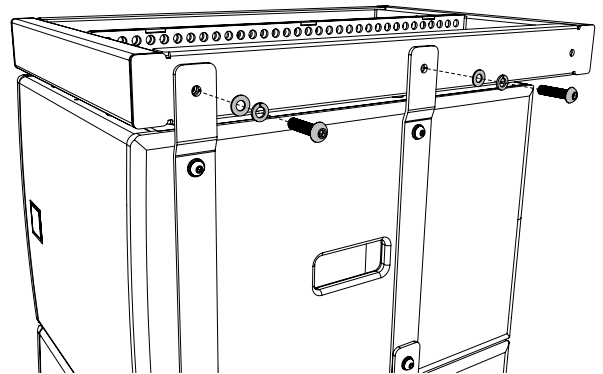

5. Lift the array into the air using a hoist.

### To add subs to the array

1. Lift the array (or single subwoofer) using a hoist, as described in the previous section.
2. Slide a sub under the array and lower the array onto this sub.
3. Unscrew the four lowest screws from the four lowest flying strips, ready to attach the lowest sub.
4. Secure the four flying strips to the lowest sub using two screws per strip and attach each strip to the sub above using one screw.

**Order of fittings:** flying strip, flat washer, spring washer, screw.

5. To attach further subs, repeat steps 1 to 4.

## Flying SX115 above WPM

To fly an array of SX115 above WPM, you need the following optional accessories:

- **SXGRIDI15 flying frame:** attach this to the top of the array.
- **FKIT450 flying kit:** you need one kit for each SX115.
- **WPMTRIGI transition grid:** install this between the subs and the WPM cabinets.



These accessories allow you to fly a maximum of three SX115 above a maximum of 12 WPM.



Flying heavy equipment in public spaces is extremely dangerous. Make sure the installer uses appropriately rated equipment and has suitable qualifications and experience.

### To fly SX115 above WPM

1. Create an array of SX115 as described in the section [Flying an array of SX115 \(page 10\)](#).
2. Use a hoist to lift the array from the ground.
3. Secure a WPMTRIGI transition grid to the bottom of the array using the M10 bolts supplied with the grid.
4. Attach WPM cabinets to the transition grid as described in the **WPM user guide**, available from our website [martin-audio.com](http://martin-audio.com).

## Flying SX115 above Torus T8

To fly an array of SX115 above Torus T8, you need the following optional accessories:

- **SXGRIDI15 flying frame:** attach this to the top of the array.
- **FKIT450 flying kit:** you need one kit for each SX115.
- **T8TRIGI transition grid:** install this between the subs and the Torus T8 cabinets.



These accessories allow you to fly a maximum of three SX115 above a maximum of six Torus T8 cabinets.



Flying heavy equipment in public spaces is extremely dangerous. Make sure the installer uses appropriately rated equipment and has suitable qualifications and experience.

### To fly SX115 above Torus T8

1. Create an array of SX115 as described in the section [Flying an array of SX115 \(page 10\)](#).
2. Lift the array from the ground using a hoist.
3. Secure a T8TRIGI transition grid to the bottom of the array using the M10 bolts supplied with the grid.
4. Attach Torus T8 cabinets to the transition grid as described in the **Torus T8 rigging manual**, available from our website [martin-audio.com](http://martin-audio.com).

## Installing a pole

The SX115 has a top-mounted M20 thread plate for installing a pole, such as the Martin Audio [wind-up telescopic pole ASF20071](#) (page 4). This pole allows you to mount a speaker with a top hat fitting and a weight up to 35 kg (77.2 lbs), such as CDD-LIVE, XD, WPM and MLA Mini. The wind-up mechanism allows you to mount the speaker at a lower level and then raise it into position.

Note that you can mount up to four WPM or MLA Mini on the ASF20071 by setting the pole at or below the level marked "Preset". The maximum load at this level is 56 kg (123.5 lbs).

### To install a pole

1. Place the cabinet on a secure platform with the round plate on the top.

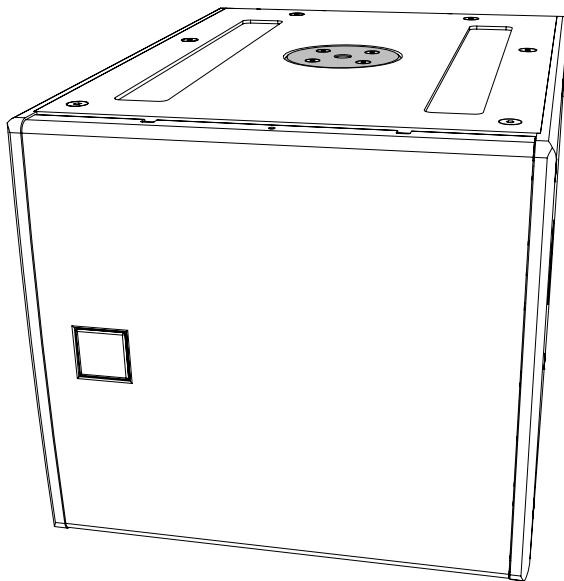

2. Screw the threaded pole into the M20 plate until secure.

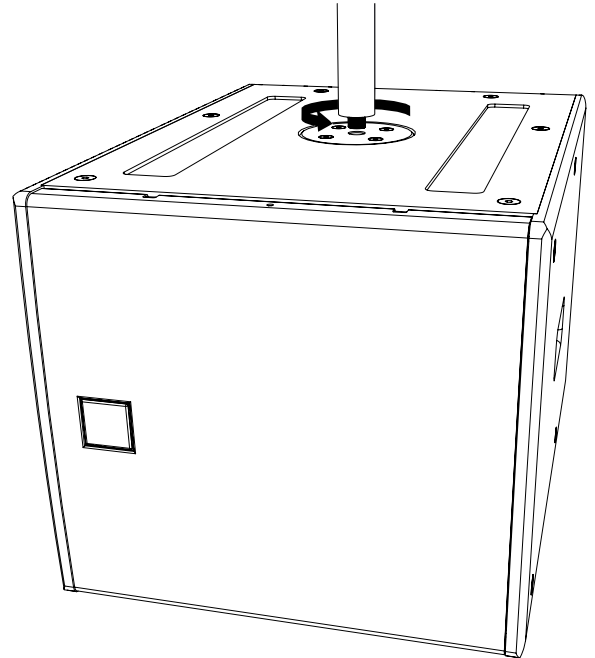

## SX115 amplifier compatibility

Amplifier	Channels	Channels used	One SX115 per channel (8 ohm)	Two SX115 per channel (4 ohm)	Three SX115 per channel (2.67 ohm)	Four SX115 per channel (2 ohm)
iK41	One channel	1 of 4	No	No	No	No
	Two channels bridged	2 of 4	Yes	−0.3	No	No
iK42	One channel	1 of 4	−0.3	−0.3	−0.3	−1.1
	Two channels bridged	2 of 4	Yes	Yes	No	No
iK81	One channel	1 of 8	−1.1	No	No	No
	Two channels bridged	2 of 8	Yes	−1.1	No	No
VIA5004	One channel	1 of 4	No	No	No	No
	Two channels bridged	2 of 4	Yes	−1.1	No	No
VIA2502	One channel	1 of 2	No	No	No	No
	Two channels bridged	2 of 2	Yes	−1.1	No	No
VIA5002	One channel	1 of 2	Yes	−1.1	No	No
	Bridging not available	NA	NA	NA	NA	NA
VIA2004	One channel	1 of 4	No	No	No	No
	Bridging not available	NA	NA	NA	NA	NA



# System controllers

For system controllers, we recommend the Martin Audio DX0.4, DX0.6 or DX4.0. Note that if you use an iKON amplifier, you don't need a system controller as these amplifiers have on-board system processing. For further details, see our website [martin-audio.com](http://martin-audio.com).

## Using other controllers

If you use a controller from another manufacturer, you need to configure settings such as crossovers, limiters and equalisation points. You can find these settings in our **Loudspeaker parameter spreadsheet**, which we provide as a free download. For details of how to use the spreadsheet, read the instructions in the spreadsheet or watch the video guide.

### To download the loudspeaker parameter spreadsheet

1. Go to our website [martin-audio.com](http://martin-audio.com).
2. Select **Support > Loudspeaker Settings**.
3. Scroll to **CURRENT-PRODUCT-PARAMETERS** and click **DOWNLOAD**.

### To view the video guide to the parameter spreadsheet

1. Go to our website [martin-audio.com](http://martin-audio.com).
2. Select **Support > Loudspeaker Settings**.
3. Scroll to **PARAMETER VIDEO** and click **VIDEO**.

# System design

To design your system and decide on the best positions for speakers and subs, we recommend Martin Audio **Display 3** software, which we provide as a free download from our website.

Display 3 allows you to model your space and experiment with various system configurations and speaker positions. Display 3 predicts the performance of your experimental configurations, allowing you to optimise the performance of your system at the design stage.

## To download Display 3

1. Visit our website [martin-audio.com](https://martin-audio.com).
2. Select **Support > Software/Firmware**.
3. Scroll to **Display 3** and click **Download**.

## EASE Focus data

For acoustic modeling of the SX115, we recommend **Display 3**. If you wish to use EASE Focus, we provide a zip file of high-resolution GLL files as a free download.

## To download GLL files

1. Visit our website [martin-audio.com](https://martin-audio.com).
2. Select **Support > Measurement Data**.
3. Scroll to **SX Series** and click **Download**.

## 3D SketchUp file

For modelling the SX115 in **Sketchup**, we provide a 3D SketchUp file as a free download.

## To download the 3D Sketchup file

1. Visit our website [martin-audio.com](https://martin-audio.com).
2. Select **Products > Product List** and click on **SX115**.
3. Select the **Technical drawings & 3D models** section and click **SKP-BLACK**.
4. For accessories, select the **Accessories** section and click **SKP-B**.

## Revit family

For modelling the SX115 in Revit, we provide a Revit family as a free download.

## To download the Revit family

1. Visit our website [martin-audio.com](https://martin-audio.com).
2. Select **Products > Product List** and click on **SX115**.
3. Select the **Technical drawings & 3D models** section and click **REVIT FILE**.

## DWG file

For viewing the SX115 technical drawing in CAD software (such as AutoCAD), we provide a DWG file as a free download.

## To download the DWG file

1. Visit our website [martin-audio.com](https://martin-audio.com).
2. Select **Products > Product List** and click on **SX115**.
3. Select the **Technical drawings & 3D models** section and click **DWG**.
4. For DWG files for accessories, select the **Accessories** section and click **DWG**.

## Other SX subwoofers

The SX Series subwoofers are a range of sub bass enclosures designed to complement Martin Audio full range systems. The range encompasses installation and touring subs, from ultra-compact miniature subs perfect as discreet, unobtrusive installation partners to the ADORN or CDD ranges, right up to very high output twin 18" models perfect for touring use in conjunction with Wavefront Precision line arrays. The larger models are built to be weather resistant and when used with an optional connector cover are suitable for occasional outdoor use as a portable system or for installation outdoors, as long as they are not directly exposed to the elements.

The range includes two powered, Dante equipped subwoofers. These are an ideal partner for CDD-LIVE. The range also includes three marine passive subwoofers for use in saltwater environments such as cruise ships and beach-side locations.

The optional accessories include eye bolts for flying smaller models, frames for flying larger models, and castors and rugged transit covers for use in touring.

For further details, visit our website [martin-audio.com](http://martin-audio.com).

### Passive SX subwoofers

		Castors	Transit cover	Weatherised connector cover	Marine version available
SX110	10" passive subwoofer	No	No	No	
SX210	Dual 10" passive subwoofer	No	No	No	
SX112	12" passive subwoofer	No	No	No	Yes
SX212	Dual 12" passive subwoofer	No	No	No	
SX115	15" passive subwoofer	Optional	Optional	Optional	
SXC115	15" passive cardioid subwoofer	Optional	Optional	No	
SXCF115	15" passive cardioid flown subwoofer	Optional	Optional	No	
SX215	Dual 15" passive subwoofer	Optional	Optional	Optional	
SX118	18" passive subwoofer	Optional	Optional	Optional	Yes
SXC118	18" passive cardioid subwoofer	Optional	Optional	Optional	
SXCF118	18" passive cardioid flown subwoofer	Optional	Optional	Optional	
SX218	Dual 18" passive subwoofer	Optional	Optional	Optional	Yes
SXH218	Hybrid® horn/reflex, dual 18" passive subwoofer	Supplied	Optional	Optional	
SXHF218	Hybrid® horn/reflex, dual 18" passive flown subwoofer	Supplied	Optional	Optional	

### Powered SX subwoofers

		Castors	Transit cover	Rain cowl
SXP118	18" powered portable subwoofer	Optional	Optional	Optional
SXP218	Dual 18" powered portable subwoofer	Optional	Optional	Optional

# SX115 specification

Type	Direct radiating subwoofer
Frequency response <sup>1</sup>	45 Hz – 100 Hz $\pm$ 3 dB, –10 dB @ 36 Hz
Drivers	LF: 15" with 4" voice coil, ferrite motor system
Rated power <sup>2</sup>	800 W AES, 3,200 W peak
Recommended amplifier	iK41
Sensitivity <sup>3</sup>	100 dB
Maximum SPL <sup>3</sup>	129 dB continuous, 135 dB peak, 141 dB peak with crest factor 4
Nominal impedance	8 ohms
Dispersion	Omni-directional or cardioid when paired
Crossover frequency	100 Hz
Enclosure	Birch plywood
Finish	Black (RAL 9005)
Grille	Perforated steel
Connectors	2 x NL4
Fittings	Two skids on base with mating channels on top M20 top-mounted thread plate for optional pole Two pocket handles 24 x M10 mounting points for optional eye bolts 16 x M8 inserts for optional castors
Dimensions	(W) 500 mm x (H) 451 mm x (D) 678 mm (806 mm with castors) (W) 19.7 in x (H) 17.8 in x (D) 26.7 in (31.7 in with castors)
Weight	36.5 kg (80.5 lbs)
Optional accessories	Set of four castors WHEELKIT Weatherised connector cover WRKIT Transit cover SX115TC M10 eye bolt HTKCT06 Wind-up telescopic pole ASF20071 Flying grid SXGRID115 Set of four flying strips FKIT450

<sup>1</sup>On-axis in open space (4 pi) at 1 m.

<sup>2</sup>AES Standard ANSI S4.26-1984.

<sup>3</sup>In half space (2 pi) at 1 m with 2.83 V input and band-limited pink noise.

# SX115 technical drawing

The drawing below shows the SX115 with castors. These are an optional accessory.

To load this drawing into CAD software, see [DWG files \(page 18\)](#).

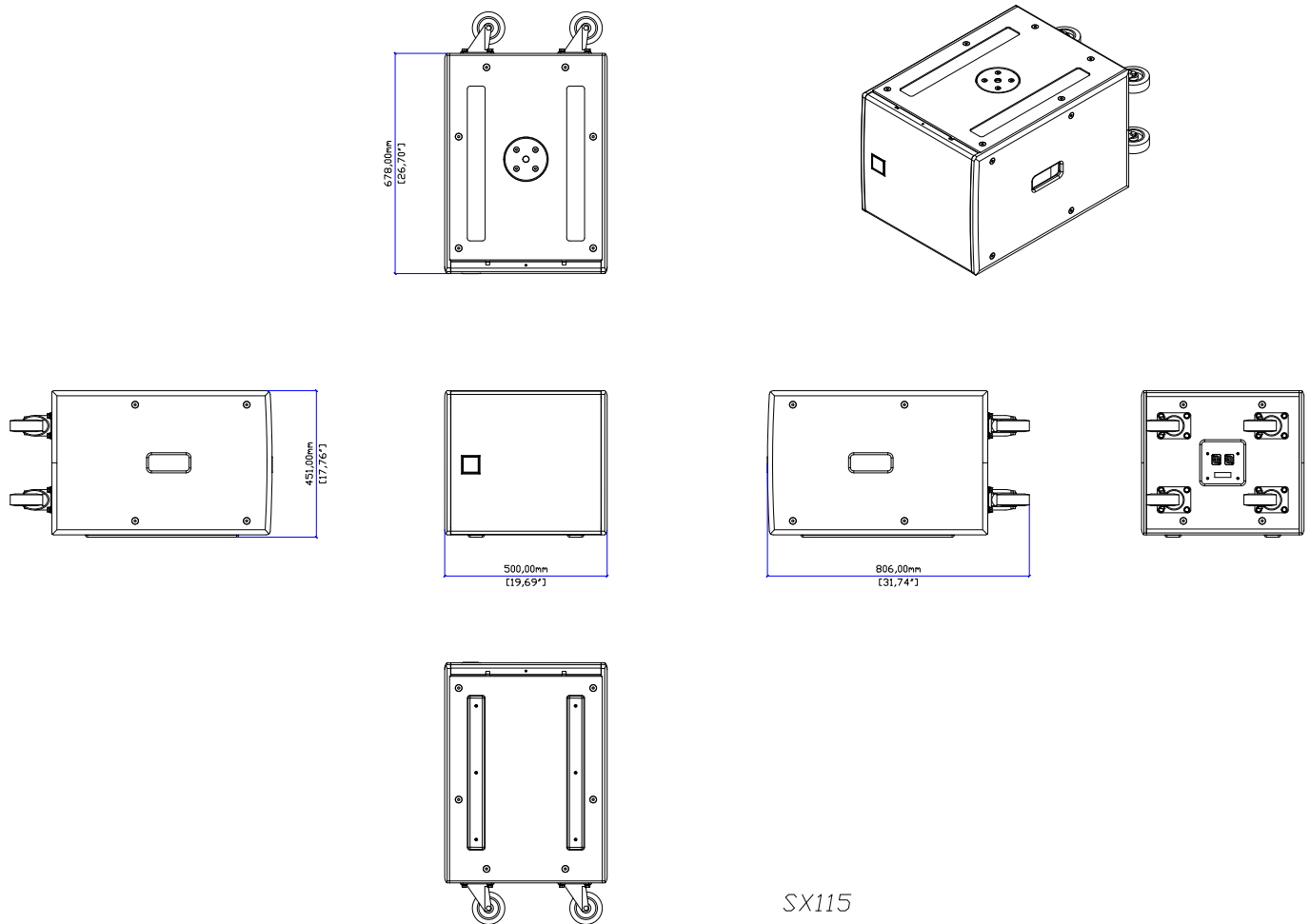

SX115

# Troubleshooting

- Sound not right. Make sure the input and output connectors are fully plugged into the sockets. Check the sound quality with headphones at the amplifier or preamp.

## Technical support

- For technical support, contact your supplier or Martin Audio technical support.
- For Martin Audio technical support, go to our website [martin-audio.com](https://martin-audio.com) and select **Support > Support Contacts**.

## Service

- For service information, go to our website [martin-audio.com](https://martin-audio.com) and select **Support > Service & Returns**.

## Warranty

- For warranty information, go to our website [martin-audio.com](https://martin-audio.com) and select **Support > Service & Returns**.

## Unpacking

After unpacking, carefully check your speakers for any signs of transit damage. If you find any issues, inform your dealer straight away. If possible, keep the packaging for future use.

## Recycling

When the product reaches the end of its life, please dispose of it responsibly at a recycling centre.

**Martin Audio Limited**

Century Point

Halifax Road

Cressex Business Park

High Wycombe

Buckinghamshire

HP12 3SL

England

**FOR SALES ENQUIRIES**

**UK**

+44 1494 535 312

info@martin-audio.com

**NORTH AMERICA**

+1 323 381 5310

**[www.martin-audio.com](http://www.martin-audio.com)**

Martin Audio, the Martin Audio logo and Hybrid are registered trademarks of Martin Audio Ltd. in the United Kingdom, United States and other countries; all other Martin Audio trademarks are the property of Martin Audio Ltd.

